

SureFlex[®]

Steerable Guiding Sheath

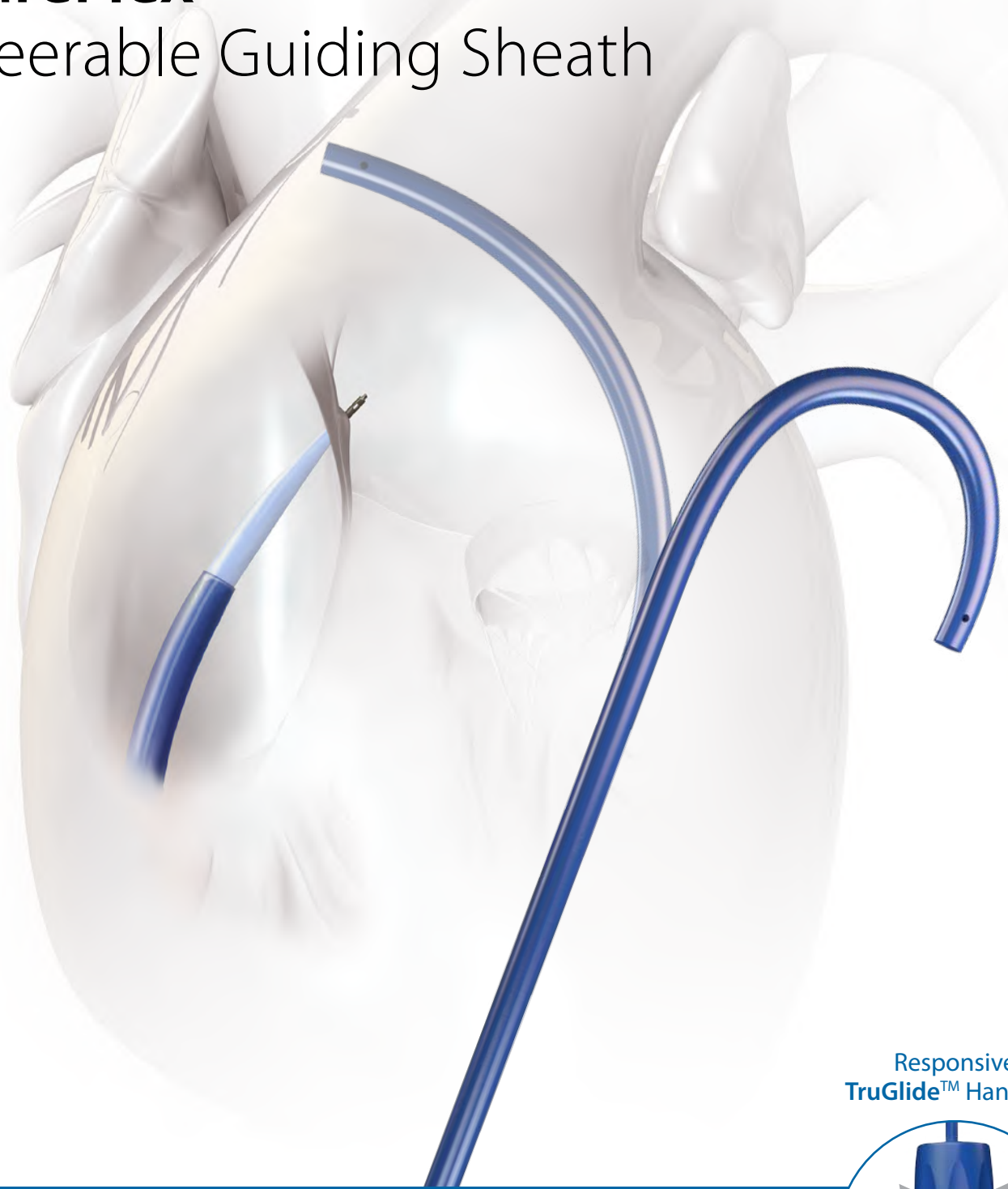

Responsive
TruGlide™ Handling



FEEL CONTROL. SEE RESULTS.™

FEEL CONTROL. SEE RESULTS.™

The **SureFlex®** Steerable Sheath has been engineered to provide maximum control throughout your entire procedure.

Schedule a case with one of our clinical specialists to experience the control for yourself.



Controlled Crossing

The advanced sheath-dilator design enables smooth and consistent access, providing you with a more predictable crossing experience.*



Precise Steering

Feel your curve, know your position. Achieve maximum precision and control* with **TruGlide™** Handling and intuitive tactile feedback.



Reliable Performance

Engineered to support consistent contact of cardiovascular catheters, while providing premium strength and durability.*

DELIVER

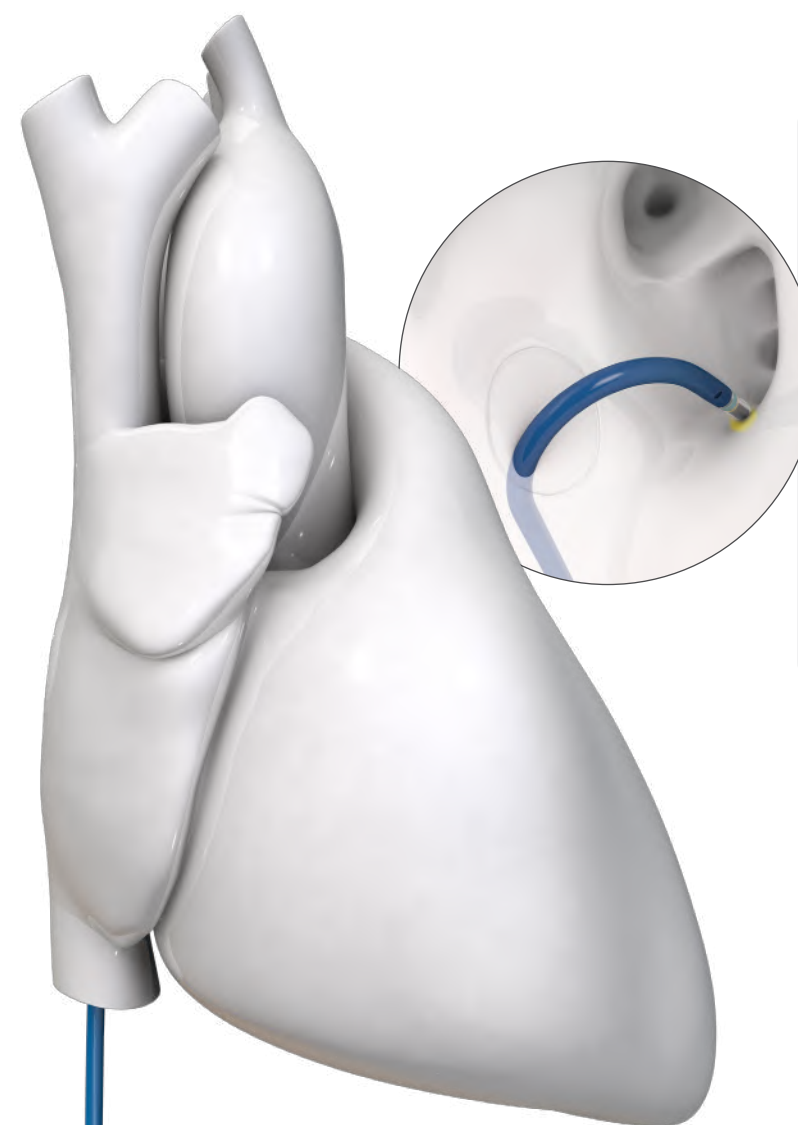

Consistent Contact Force

Support the consistent contact force of catheters.^{1*} Consistent contact force of ablation catheters provides better therapeutic results.²

Strength and Durability

High performance; greater durability than the leading competitor.*

Engineered to retain your curve throughout the procedure.



Self-locking Dial

Maintain your position - deliver therapy on target as the dial retains your curve.

EVERY TIME.

CROSS

Confidence in Crossing

Gain access with confidence:

- A **27%** lower peak crossing force, with a smoother profile.*

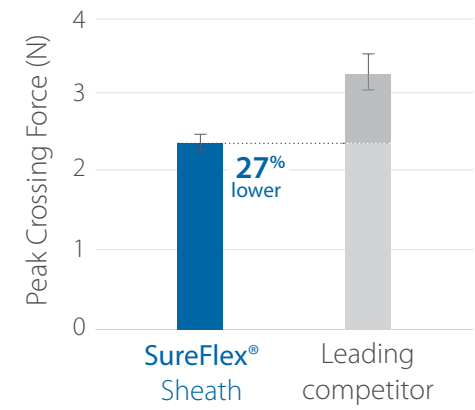

Smooth Transition

A **40%** smoother dilator-to-sheath transition than the leading competitor,* to facilitate a smoother crossing.

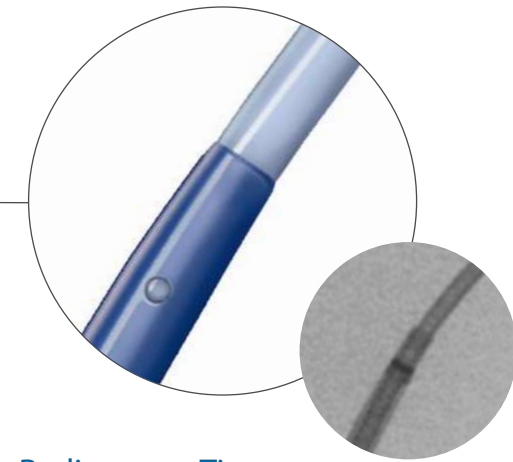

Radiopaque Tip

Control your position by visualizing sheath tip location during the procedure.

TARGET

Responsive TruGlide™ Handling

Smooth, high-precision steering to confidently position your curve.

Tactile Feedback

Feel the extent of your curve deflection with intuitive tactile feedback.

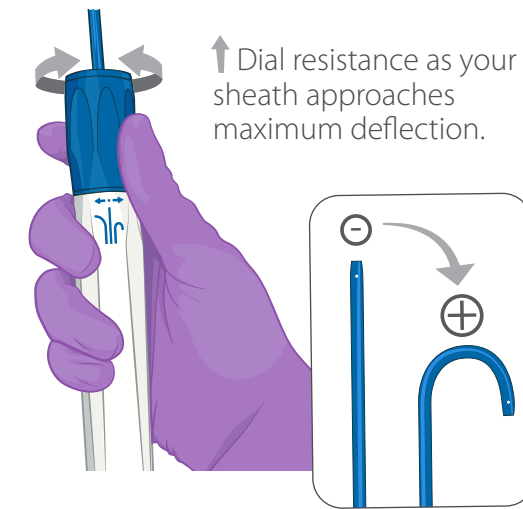

Controlled Torque

Position yourself accurately with a 1:1 torque response,* enabled by a composite braid design.

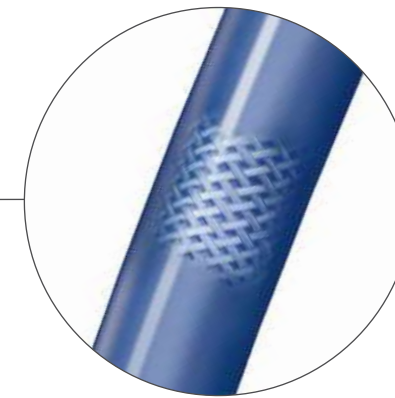

DELIVER



Consistent Contact Force

Support the consistent contact force of catheters.^{1*} Consistent contact force of ablation catheters provides better therapeutic results.²

Strength and Durability

High performance; greater durability than the leading competitor.*

Engineered to retain your curve throughout the procedure.



Self-locking Dial

Maintain your position - deliver therapy on target as the dial retains your curve.

EVERY TIME.

SureFlex® Steerable Guiding Sheath



SPECIFICATIONS

Feature	Specification
French size compatibility	8.5F (2.8 mm)
Sheath usable length	71 cm
Sheath overall length	91 cm
Sheath radiopaque marker	Platinum/iridium band
Dilator usable length	94 cm
Guidewire length	180 cm
Compatible guidewire	0.032" (0.81 mm)
Bidirectional curve angles	90° CCW, 180° CW

ORDERING INFORMATION

Product Number	Distal Curve Diameter
TSK85-32-BD-71S	Small (17 mm)
TSK85-32-BD-71M	Medium (22 mm)
TSK85-32-BD-71L	Large (50 mm)



¹ Brunelli M, et al. Europace. doi: 10.1093/europace/eur333

² Piorkowski C, et al. Circ Arrhythm Electrophysiol. doi: 10.1161/CIRCEP.110.957761