

NRG[®] RF Transseptal Kit



TAKE CONTROL OF YOUR CROSSING[™]

TARGET 1

TO SAVE TIME

NRG® Transseptal Needle



Blunt Tip

Fine tune your position on the septum before crossing

Radiopaque Tip

Control your positioning by visualizing needle tip location

TorFlex™ Transseptal Guiding Sheath

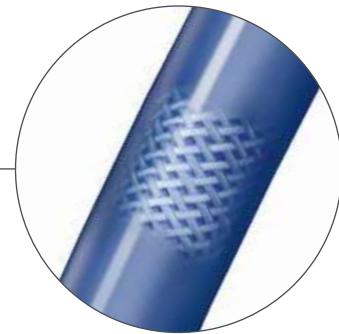

Controlled Torque

Special braid composite design for ideal torque transmission

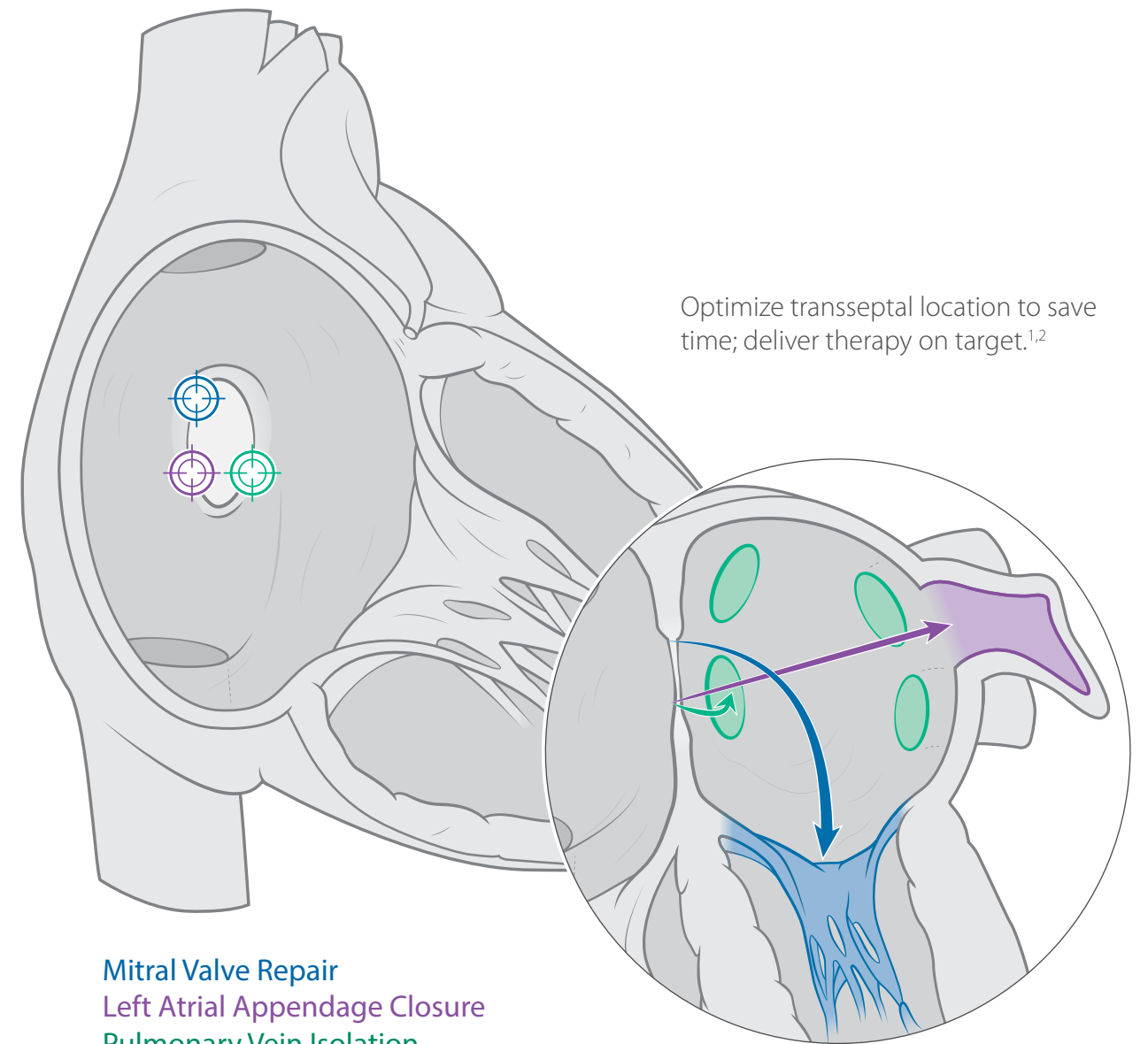

Optimize transseptal location to save time; deliver therapy on target.^{1,2}

Mitral Valve Repair
Left Atrial Appendage Closure
Pulmonary Vein Isolation

BE PRECISE. SAVE TIME.™

TARGET 1

NRG® Transseptal Needle



Blunt Tip

Fine tune your position on the septum before crossing

Radiopaque Tip

Control your positioning by visualizing needle tip location

TorFlex™ Transseptal Guiding Sheath

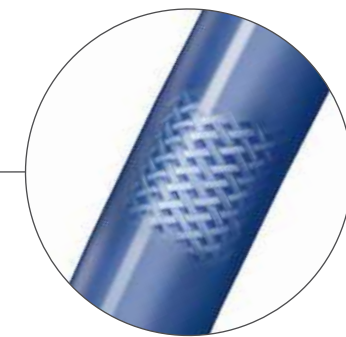

Controlled Torque

Special braid composite design for ideal torque transmission

BE PRECISE. SAVE TIME.™

CROSS 2

NRG® Transseptal Needle

Proven RF Puncture Technology

Reliably cross normal, aneurysmal and fibrotic septa^{3,4} using a short, focused RF energy pulse

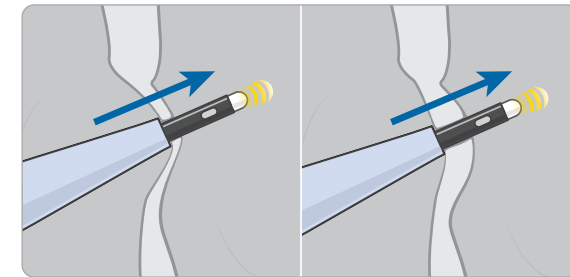

Aneurysmal Septum Fibrotic Septum

Control your crossing through

- Reduced excessive tenting³
- Reduced mechanical force⁴
- Reduced needle jumping

TorFlex™ Transseptal Guiding Sheath

Radiopaque Band

Visualize distal sheath location

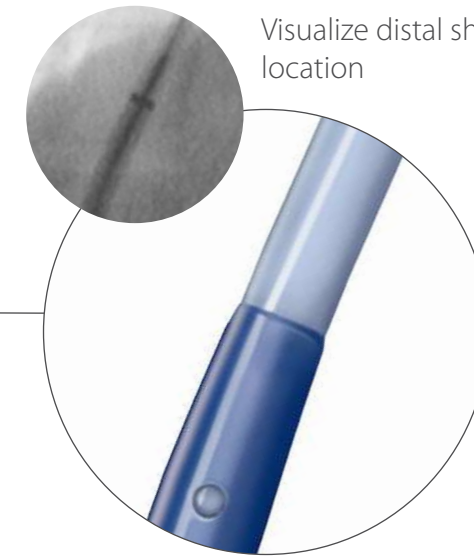

Smooth Transition

Facilitate advancement across septum with a sleek dilator-to-sheath profile

SMOOTH AND CONTROLLED CROSSING.™

ACCESS 3

Stiff Body

Facilitate exchange of large sheaths

Soft Tip

Reduce risk of perforation

Radiopaque Wire

Visualize wire location

ProTrack™ Pigtail Wire

Instant Anchor

Save time: simply deploy the pigtail wire, with no need to probe, and insert guidewire in a pulmonary vein.⁵

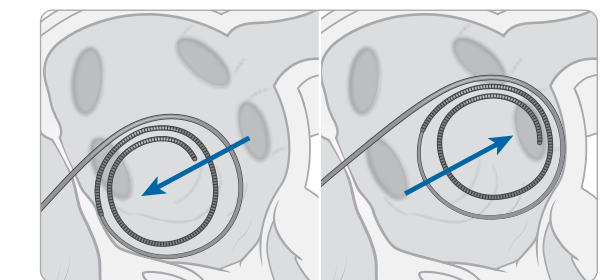

Prevent loss of left atrium access

Cushion against left atrial wall

INSTANT ANCHOR. SECURE ACCESS.™

NRG® RF Transseptal Kit

Each kit includes (in individual packaging)



- (1) **NRG®** Transseptal Needle
- (1) **TorFlex™** Transseptal Guiding Sheath
- (1) **ProTrack™** Pigtail Wire

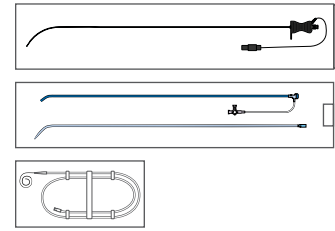

CUSTOMIZE YOUR KIT

A Choose your needle curve

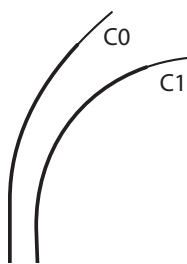

NRG® Transseptal Needle

Needle length: 71 cm
Proximal gauge: 18 ga
Distal gauge: 21 ga

B Choose your sheath curve

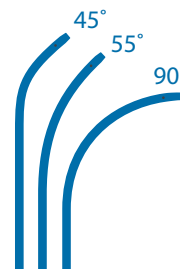

TorFlex™ Transseptal Guiding Sheath

French size compatibility: 8.5F (2.84 mm)
Sheath usable length: 63 cm
Dilator usable length: 67 cm

C Choose your pigtail wire*

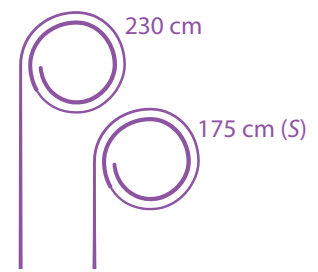

ProTrack™ Pigtail Wire

Wire diameter: 0.025 in
Overall length: 230 cm or 175 cm

KIT MODEL NUMBERS

For use with Baylis Medical Company Radiofrequency Puncture Generator **RFP-100A** or BMC Radiofrequency Puncture Generator **RFP-100**.

*Ask your sales representative about additional options for the **ProTrack™** Pigtail Wire.

RFP-100A

	A	B	C	
NTK-71	0 -85	45		230 cm
NTK-71	0 -85	55		
NTK-71	0 -85	90		
NTK-71	1 -85	45		230 cm
NTK-71	1 -85	55		
NTK-71	1 -85	90		
NTK-71	0 -85	45	S	175 cm*
NTK-71	0 -85	55	S	
NTK-71	1 -85	45	S	
NTK-71	1 -85	55	S	

RFP-100

	A	B	C	
NTK-P71	0 -85	45		230 cm
NTK-P71	0 -85	55		
NTK-P71	0 -85	90		
NTK-P71	1 -85	45		230 cm
NTK-P71	1 -85	55		
NTK-P71	1 -85	90		
NTK-P71	0 -85	45	S	175 cm*
NTK-P71	0 -85	55	S	
NTK-P71	1 -85	45	S	
NTK-P71	1 -85	55	S	

¹Rich ME, et al. J Vis Exp. doi: 10.3791/52811

²Rinaldi MJ, et al. Site-specific transseptal puncture for emerging structural heart interventions. Cardiac Interv Today. 2014 Mar-Apr.

³Sharma G, et al. Catheter Cardio Inte. doi: 10.1002/ccd.26608.

⁴Smelley MP, et al. J Cardiovasc Electr. doi: 10.1111/j.1540-8167.2009.01656.x

⁵Buchner S, et al. J Interv Cardiol. doi: 10.1111/joic.12224

PRM-00037 EN J-1,2 V-4 © Copyright Baylis Medical Company Inc., 2016-2022. Baylis Medical Company Inc. reserves the right to change specifications or to incorporate design changes without notice and without incurring any obligation relating to equipment previously manufactured or delivered. NRG, TorFlex, ProTrack, "Take Control of Your Crossing", "Be Precise. Save Time.", "Smooth and Controlled Crossing", "Instant Anchor. Secure Access", and the Baylis Medical logo are trademarks and/or registered trademarks of Baylis Medical Company Inc. in the USA and/or other countries. Patents Pending and/or issued. CAUTION: Federal Law (USA) restricts the use of these devices to or by the order of a physician. Before use, consult product labels and Instructions for Use for Indications for Use, Contraindications, Warnings, Precautions, Adverse Events and Directions for Use.

Products shown may not be approved in all jurisdictions.

Baylis
MEDICAL

Baylis Medical Company Inc.
5959 Trans-Canada Highway
Montreal, QC Canada H4T 1A1

Tel.: (514) 488-9801 / Fax: (514) 488-7209
www.baylismedical.com / info@baylismedical.com